



X-ONE TRUCK CAP

8-DOOR

ICONIC X

BED SIZES:

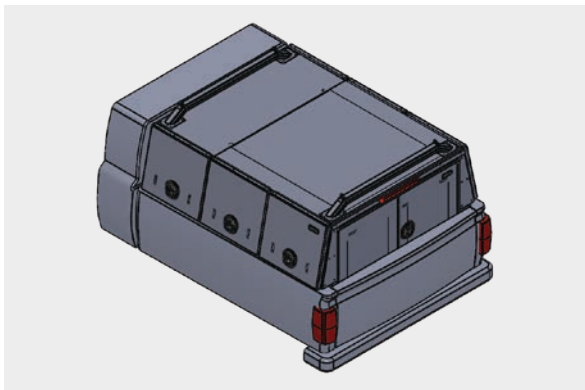

REGULAR BOX (PAGE 3)

[GO TO REGULAR BOX](#)

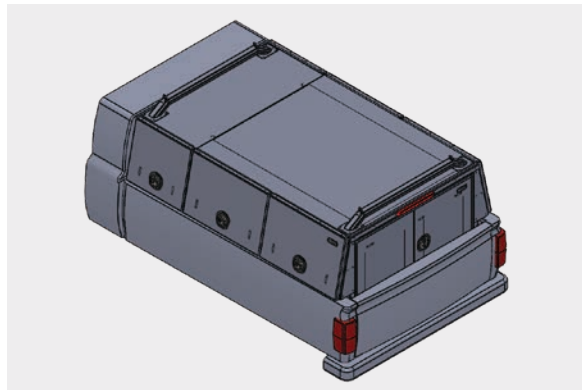

LONG BOX (PAGE 9)

[GO TO LONG BOX](#)



NEW! FLIP UP REAR DOOR

Choose to swap the X-ONE's standard rear barn doors for a single flip-up door. **Now available for every size and configuration.**

X-ONE CONFIGURATIONS:
8-DOOR VERSION



X-ONE Truck Pack

REGULAR BOX (APROX 6.6 FT.)

8 - DOOR

CAB HEIGHT

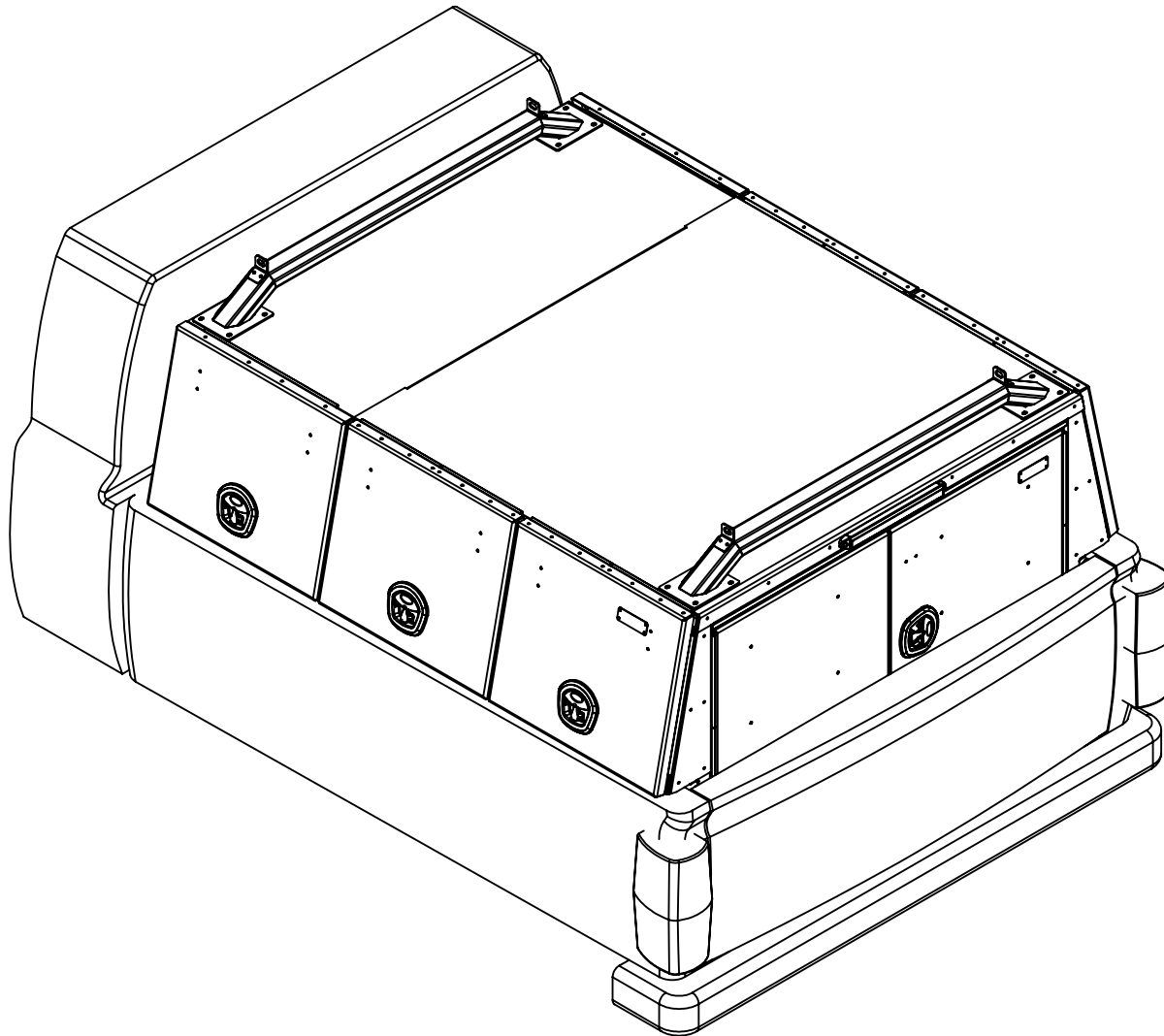

5

4

3

2

1

D

C

B

A

LADDER RACK CAPACITY
750LBS (EVENLY DISTRIBUTED) ALL DOORS

ALL DOORS
HAVE GAS SHOCKS

3rd LED TAIL LIGHT

COATED PANEL

WHALE TAIL HANDLE
CHROME, LOCKING

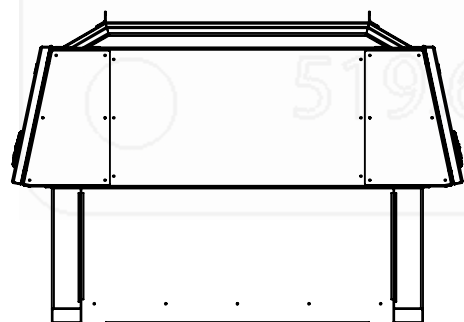

49.00
 Drop-In Compartment
 Width (Front)

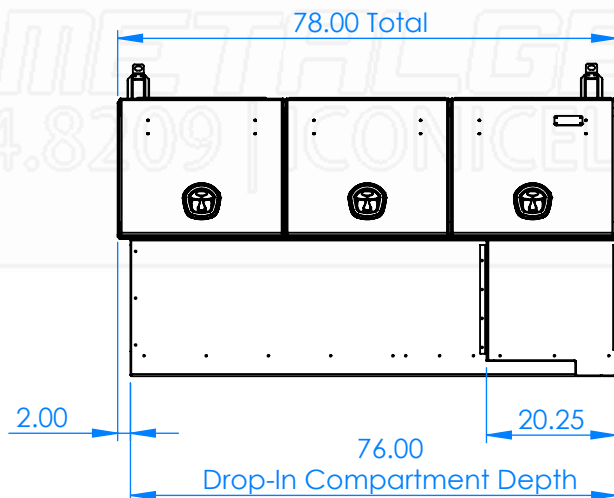

2.00

76.00
 Drop-In Compartment Depth

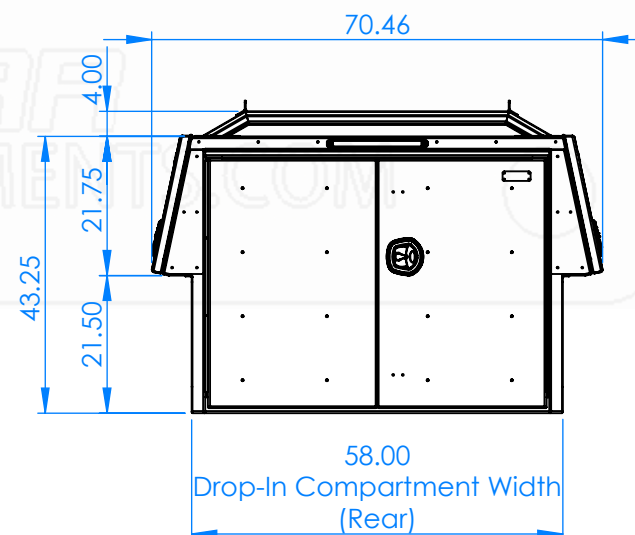

58.00
 Drop-In Compartment Width
 (Rear)

Part No.:

3060

MATERIAL: 5052 (Alum)

THICKNESS: 0.125

FINISH: Powder

DWG. NO.: 4128-0-00-B

Approx. Weight: 602.71 lbs

Surf. Area: 636.17 sq. ft.

ICONIC ELEMENTS (ICONIC METALGEAR)

PROPRIETARY AND CONFIDENTIAL
 NO PART OF THIS DOCUMENT MAY BE REPRODUCED, STORED IN A RETRIEVAL SYSTEM, OR TRANSMITTED
 IN ANY FORM, WITHOUT THE WRITTEN PERMISSION OF Iconic Elements Inc. (ICONIC METALGEAR)

TITLE:

Iconic X-One Pack

REV: SHEET:

B 2 OF 6

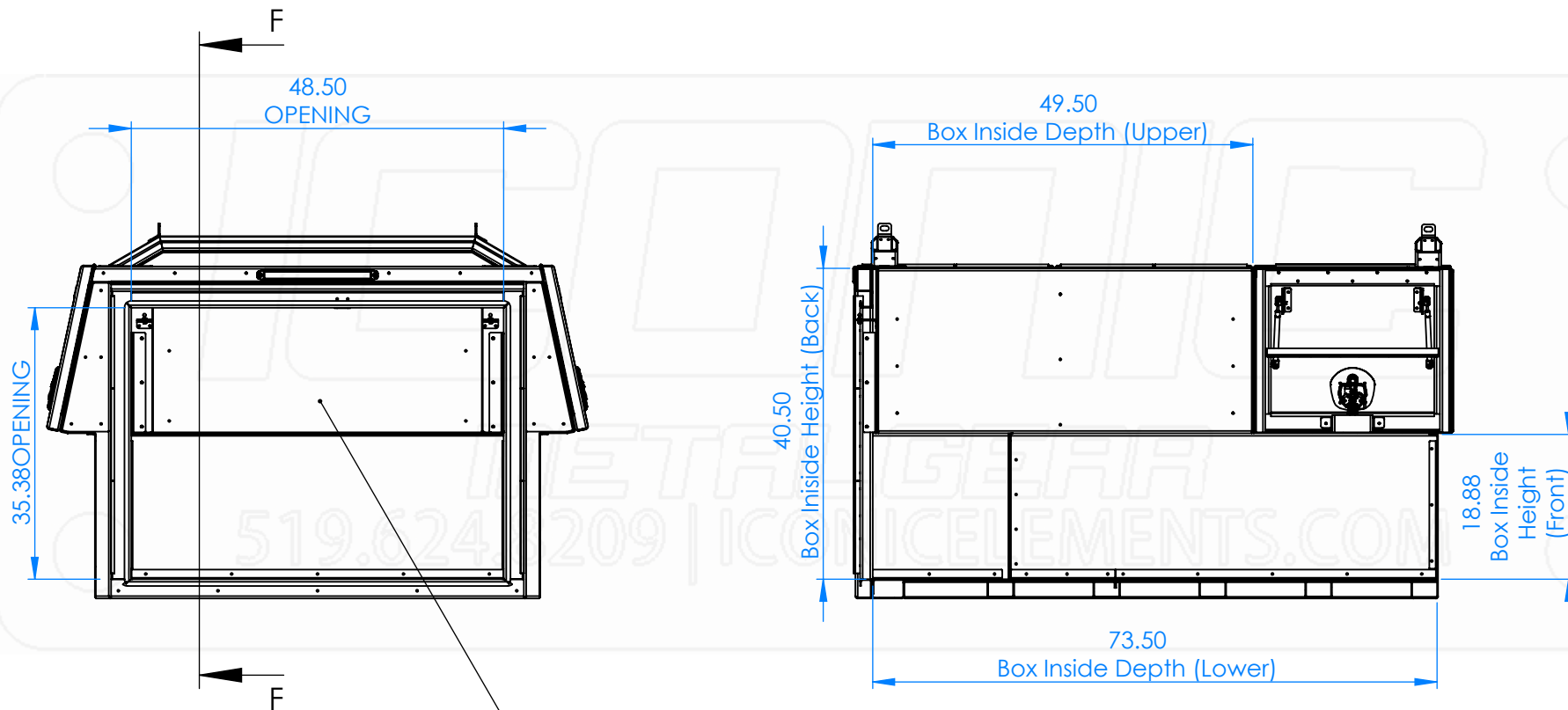

Part No.:	MATERIAL: 5052 (Alum)	THICKNESS: 0.125	FINISH: Powder	DWG. NO.: 4128-0-00-B
3060	Approx. Weight: 602.71 lbs	ICONIC ELEMENTS (ICONIC METALGEAR)		REV: SHEET:
	Surf. Area: 636.17 sq. ft.	<small>PROPRIETARY AND CONFIDENTIAL NO PART OF THIS DOCUMENT MAY BE REPRODUCED, STORED IN A RETRIEVAL SYSTEM, OR TRANSMITTED IN ANY FORM, WITHOUT THE WRITTEN PERMISSION OF Iconic Elements Inc. (ICONIC METALGEAR)</small>		B 3 OF 6
5	4	3	2	1

Iconic X-One Pack

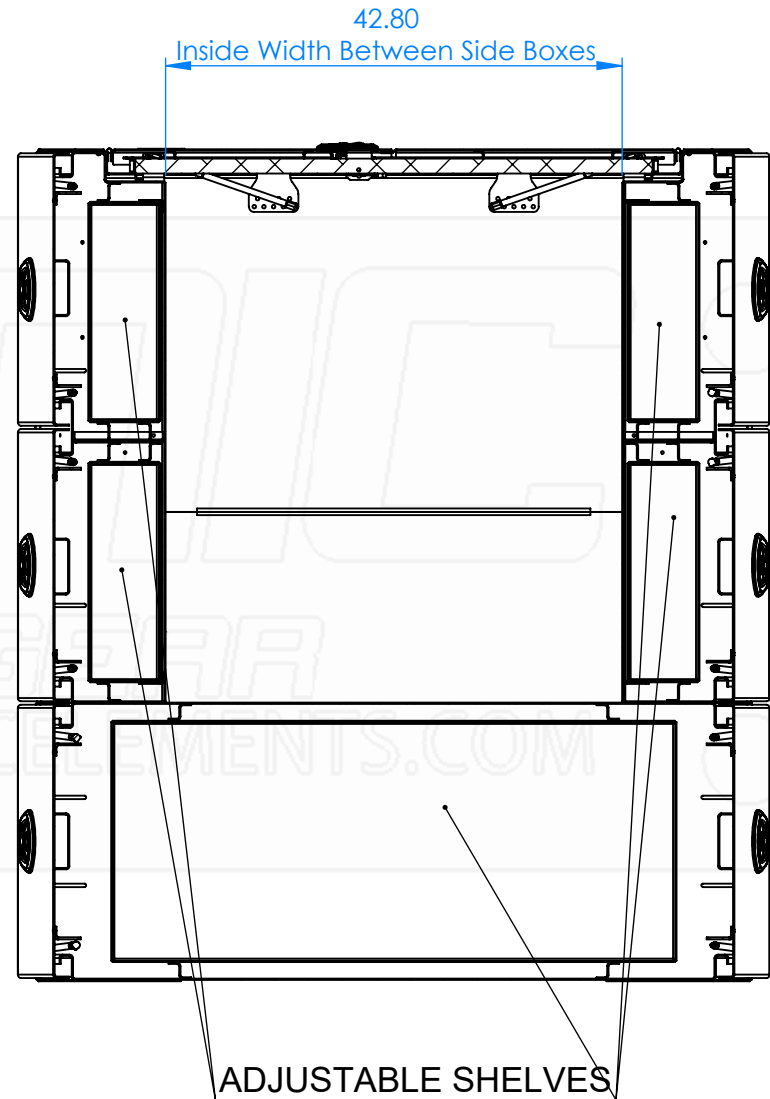
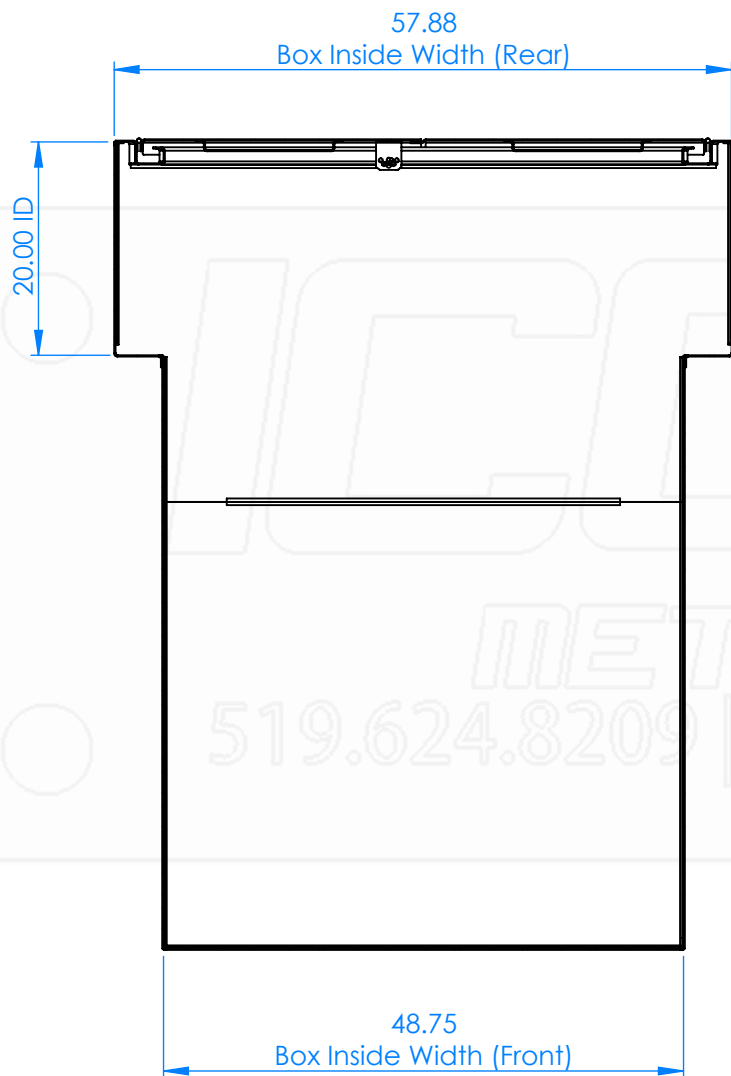

Part No.:

3060

MATERIAL: 5052 (Alum)

THICKNESS: 0.125

FINISH: Powder

DWG. NO.: 4128-0-00-B

Approx. Weight: 602.71 lbs

Surf. Area: 636.17 sq. ft.

ICONIC ELEMENTS (ICONIC METALGEAR)

PROPRIETARY AND CONFIDENTIAL
NO PART OF THIS DOCUMENT MAY BE REPRODUCED, STORED IN A RETRIEVAL SYSTEM, OR TRANSMITTED IN ANY FORM, WITHOUT THE WRITTEN PERMISSION OF Iconic Elements Inc. (ICONIC METALGEAR)

TITLE:

Iconic X-One Pack

REV: SHEET:

B 4 OF 6

5

4

3

2

1

D

C

B

A

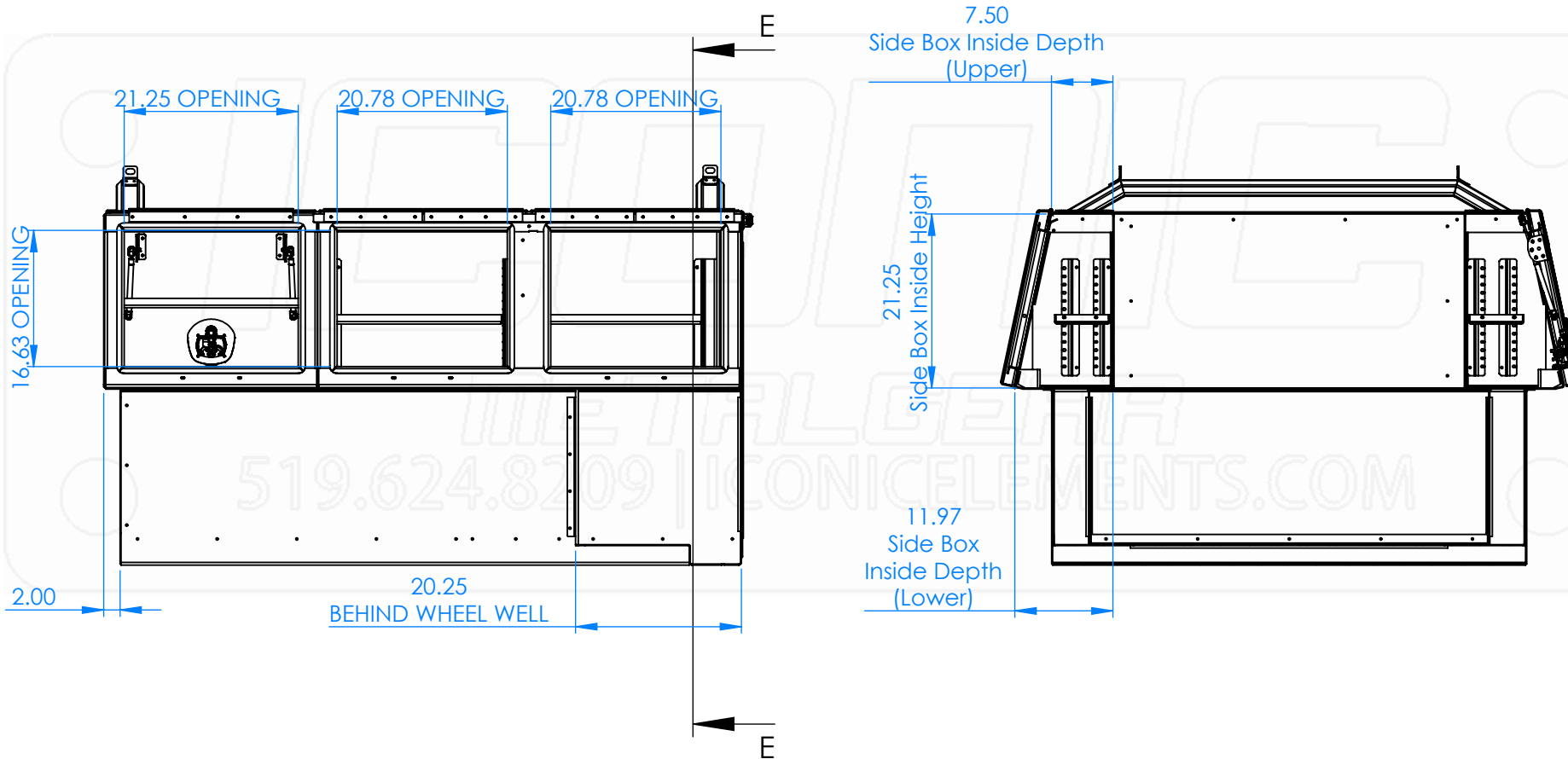

Part No.: 3060	MATERIAL: 5052 (Alum) Approx. Weight: 602.71 lbs Surf. Area: 636.17 sq. ft.	THICKNESS: 0.125 ICONIC ELEMENTS (ICONIC METALGEAR) <small>PROPRIETARY AND CONFIDENTIAL NO PART OF THIS DOCUMENT MAY BE REPRODUCED, STORED IN A RETRIEVAL SYSTEM, OR TRANSMITTED IN ANY FORM, WITHOUT THE WRITTEN PERMISSION OF Iconic Elements Inc. (ICONIC METALGEAR)</small>	FINISH: Powder TITLE: Iconic X-One Pack	DWG. NO.: 4128-0-00-B REV: B SHEET: 5 OF 6
5	4	3	2	1

INSTALLATION GUIDE

**APPROX 3 HOURS INSTALL
(CONTACT AUTO SHOP FOR
HOOKING UP 3rd BRAKE LIGHT WIRING)**

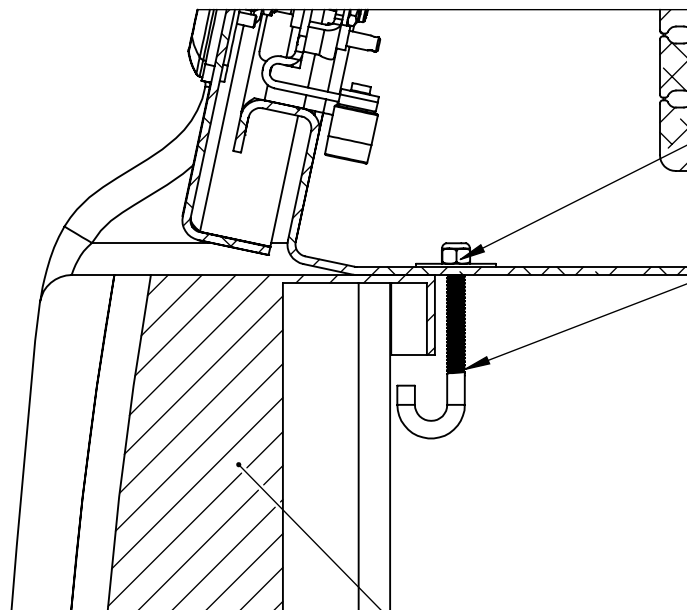
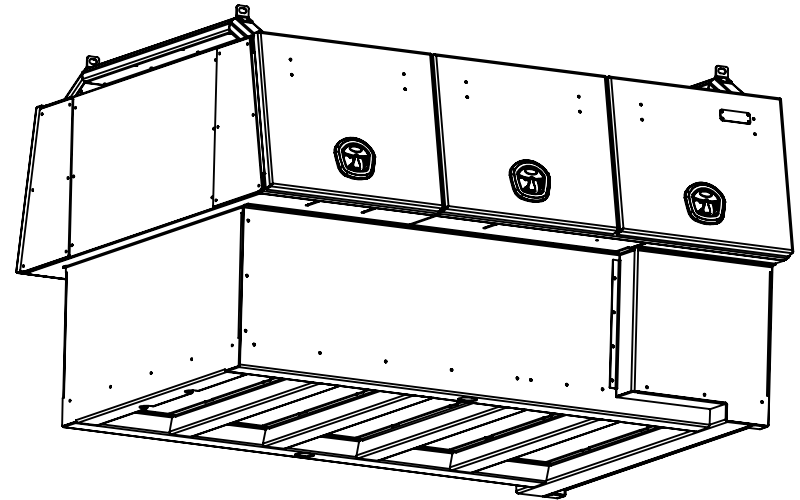

CUT EXCESS OFF

INCLUDED HARDWARE

TRUCK BED RAIL

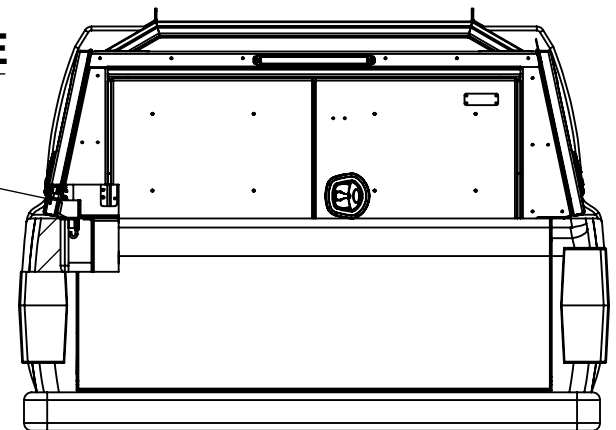

X-ONE Truck Pack
LONG BOX (APROX 8 FT.)
8 - DOOR
CAB HEIGHT

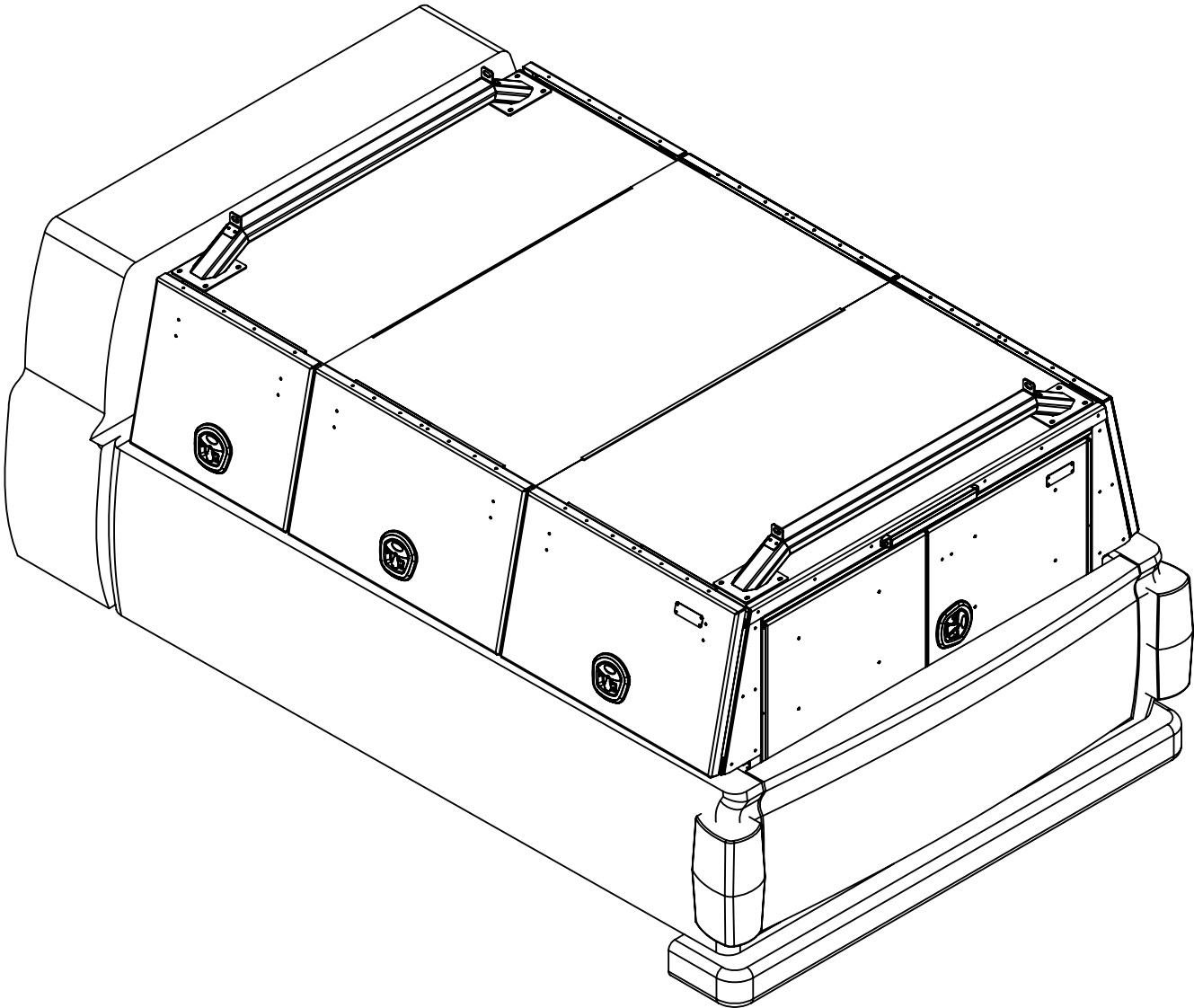

D

C

B

A

5

4

3

2

1

**LADDER RACK CAPACITY
750LBS (EVENLY DISTRIBUTED)**

**ALL DOORS
HAVE GAS SHOCKS**

3rd LED TAIL LIGHT

COATED PANEL

**WHALE TAIL HANDLE
CHROME, LOCKING**

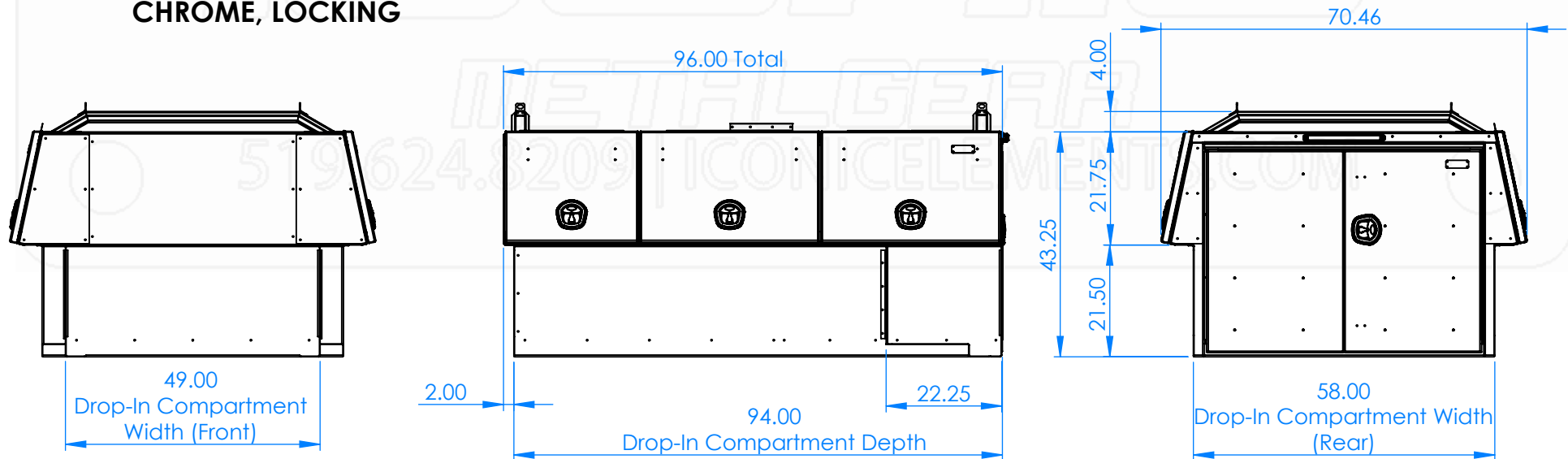

Part No.:

3061

MATERIAL: 5052 (Alum)

THICKNESS: 0.125

FINISH: Powder

DWG. NO.: 4129-0-00-B

Approx. Weight: 782.63 lbs

Surf. Area: 831.71 sq. ft.

ICONIC ELEMENTS (ICONIC METALGEAR)

PROPRIETARY AND CONFIDENTIAL
NO PART OF THIS DOCUMENT MAY BE REPRODUCED, STORED IN A RETRIEVAL SYSTEM, OR TRANSMITTED
IN ANY FORM, WITHOUT THE WRITTEN PERMISSION OF Iconic Elements Inc. (ICONIC METALGEAR)

TITLE:

Iconic X-One Pack

REV: SHEET:

B 2 OF 6

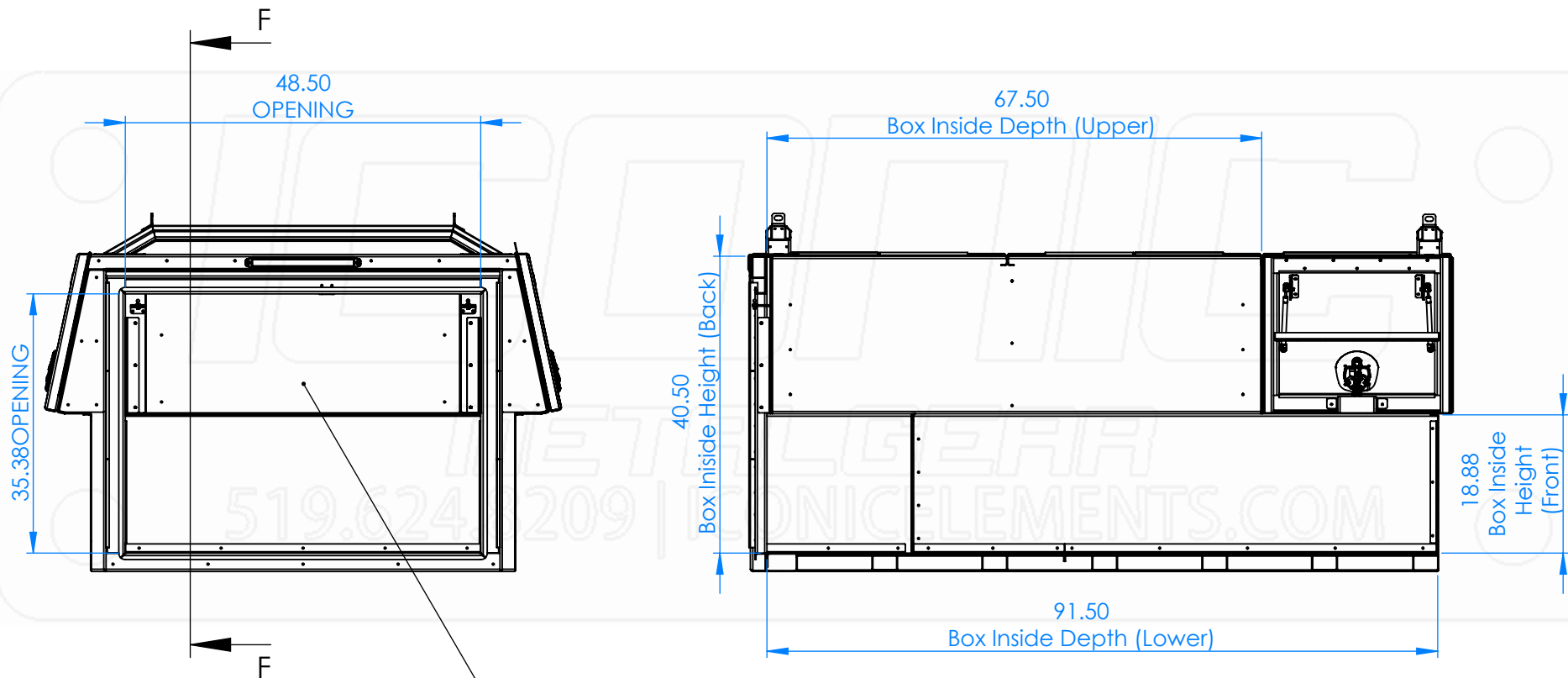

Part No.:	MATERIAL: 5052 (Alum)	THICKNESS: 0.125	FINISH: Powder	DWG. NO.: 4129-0-00-B
3061	Approx. Weight: 782.63 lbs	ICONIC ELEMENTS (ICONIC METALGEAR)		REV: SHEET:
	Surf. Area: 831.71 sq. ft.	<small>NO PART OF THIS DOCUMENT MAY BE REPRODUCED, STORED IN A RETRIEVAL SYSTEM, OR TRANSMITTED IN ANY FORM, WITHOUT THE WRITTEN PERMISSION OF Iconic Elements Inc. (ICONIC METALGEAR)</small>		B 3 OF 6
		Iconic X-One Pack		

5

4

3

2

1

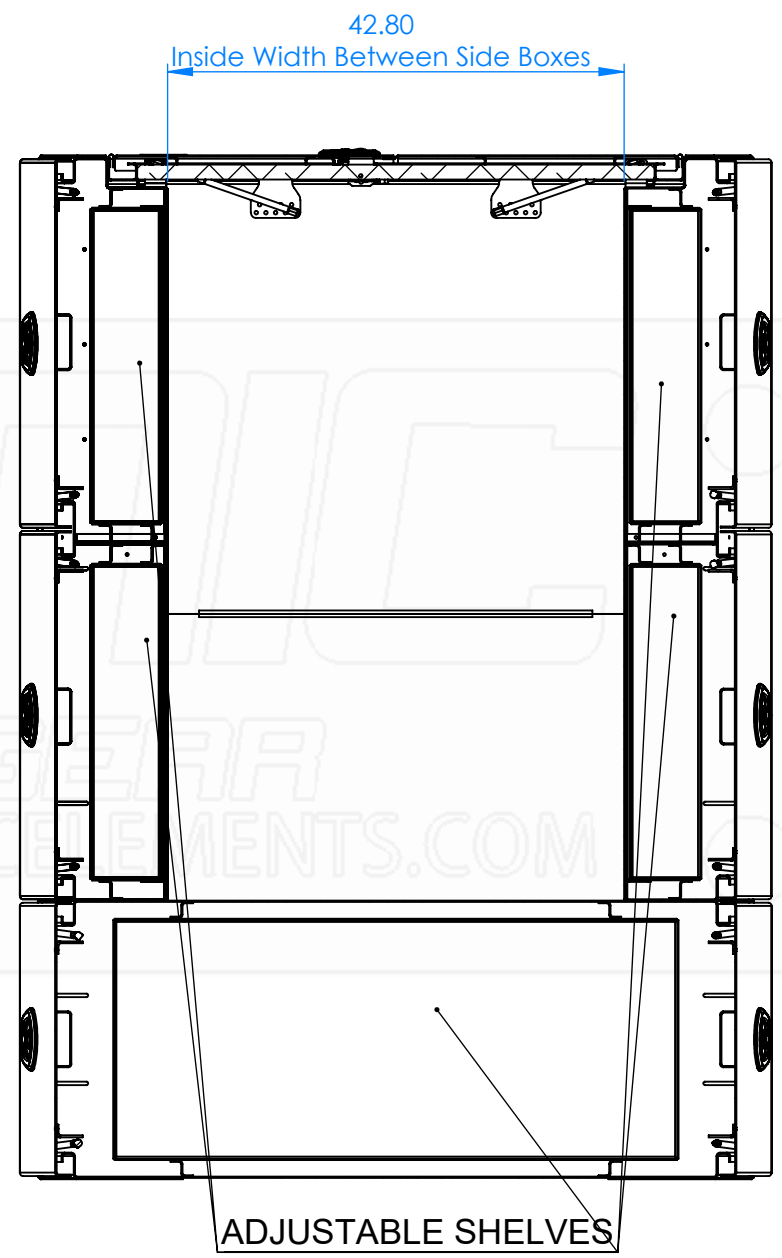
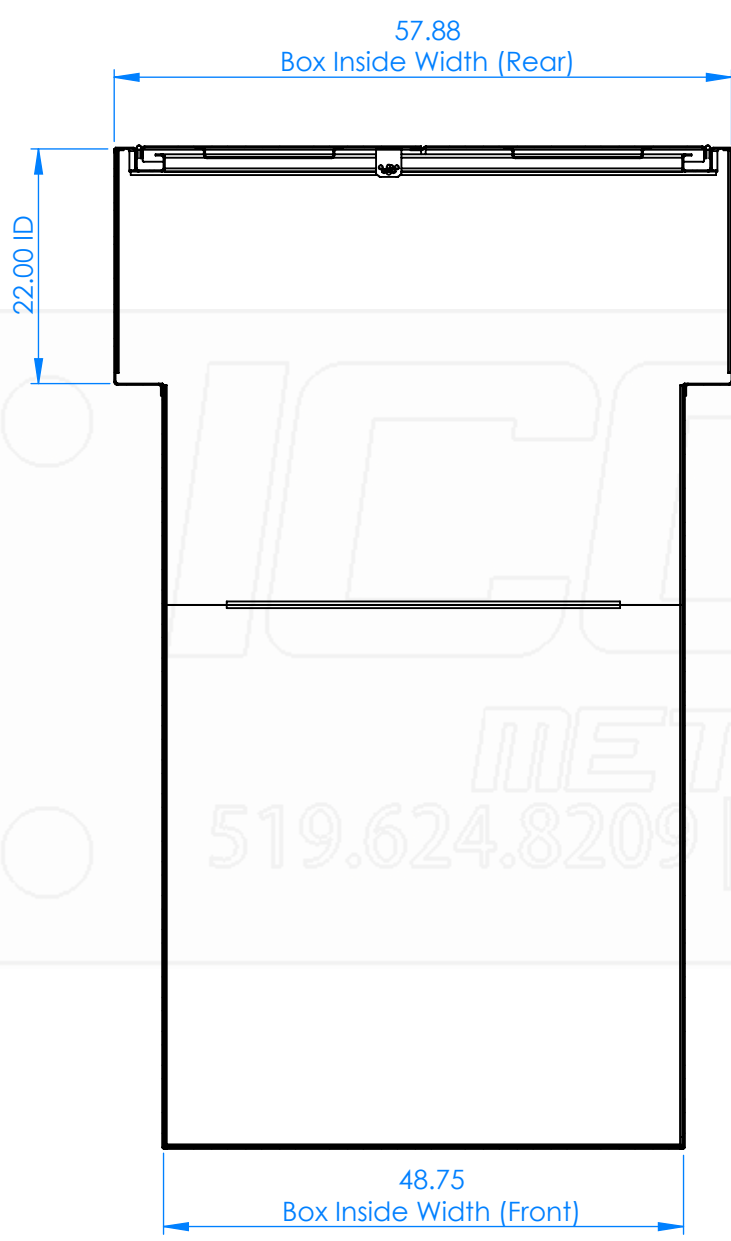

Part No.:	MATERIAL: 5052 (Alum)	THICKNESS: 0.125	FINISH: Powder	DWG. NO.: 4129-0-00-B
3061	Approx. Weight: 782.63 lbs Surf. Area: 831.71 sq. ft.	ICONIC ELEMENTS (ICONIC METALGEAR) TITLE: <small>PROPRIETARY AND CONFIDENTIAL NO PART OF THIS DOCUMENT MAY BE REPRODUCED, STORED IN A RETRIEVAL SYSTEM, OR TRANSMITTED IN ANY FORM, WITHOUT THE WRITTEN PERMISSION OF Iconic Elements Inc. (ICONIC METALGEAR)</small>		Iconic X-One Pack REV: B SHEET: 4 OF 6
	5	4	3	

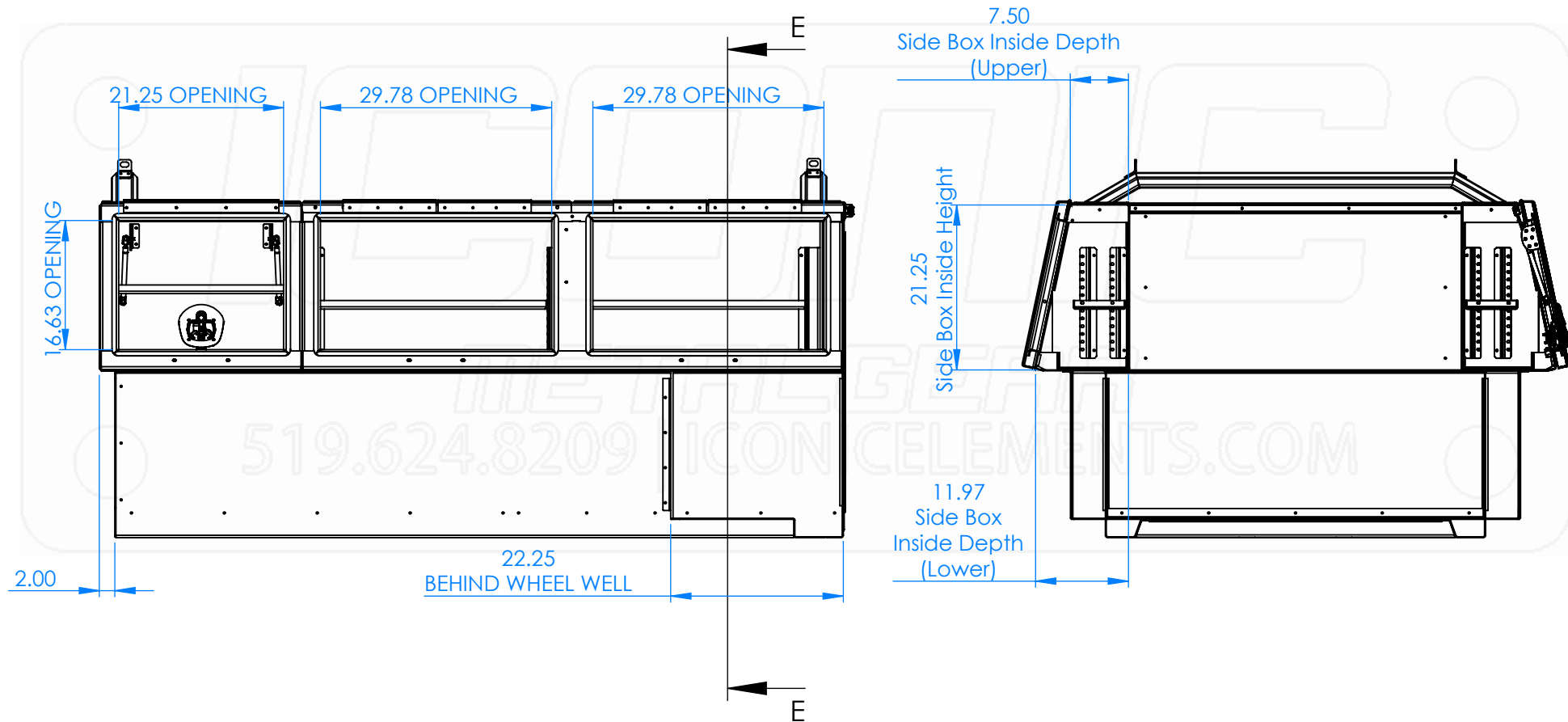

Part No.: 3061	MATERIAL: 5052 (Alum)		THICKNESS: 0.125	FINISH: Powder	DWG. NO.: 4129-0-00-B	REV: B	SHEET: 5 OF 6
	Approx. Weight: 782.63 lbs	ICONIC ELEMENTS (ICONIC METALGEAR)		TITLE: Iconic X-One Pack			
	Surf. Area: 831.71 sq. ft.	<small>PROPRIETARY AND CONFIDENTIAL NO PART OF THIS DOCUMENT MAY BE REPRODUCED, STORED IN A RETRIEVAL SYSTEM, OR TRANSMITTED IN ANY FORM, WITHOUT THE WRITTEN PERMISSION OF Iconic Elements Inc. (ICONIC METALGEAR)</small>					

INSTALLATION GUIDE

**APPROX 3 HOURS INSTALL
(CONTACT AUTO SHOP FOR
HOOKING UP 3rd BRAKE LIGHT WIRING)**

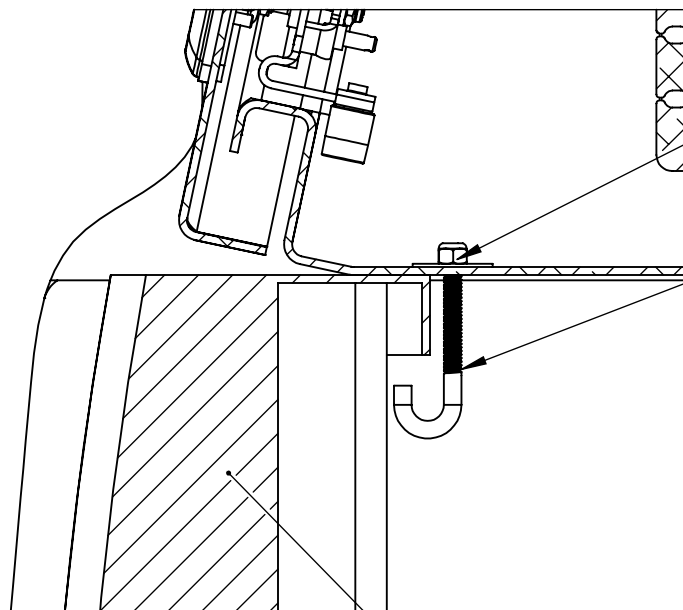
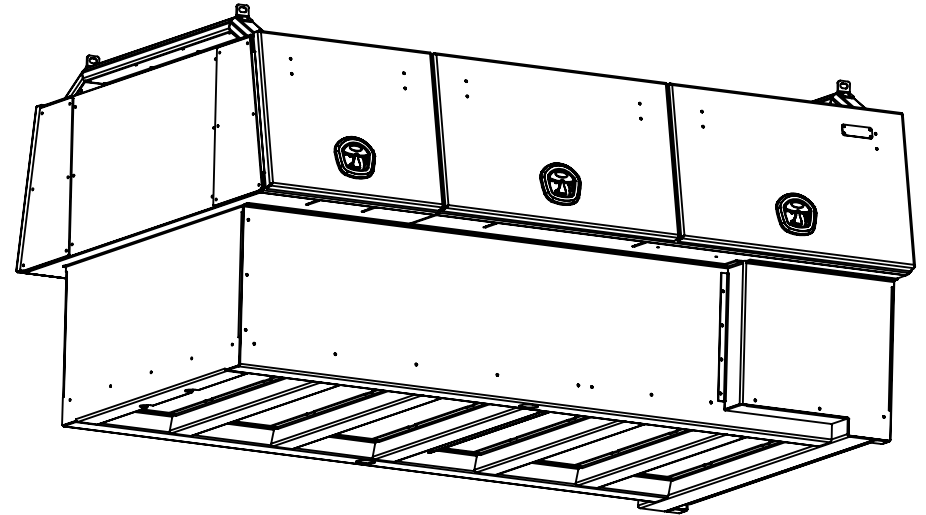

CUT EXCESS OFF

INCLUDED HARDWARE

TRUCK BED RAIL

